

# COVID-19 Nucleic Acid Amplification Nasal Swab (anterior nares)

## Collection Information

This specimen collection kit is acceptable and must be used **ONLY** for the collection of LabCorp's 2019 Novel Coronavirus (COVID-19) assay [139900] from the anterior nares (nasal collection).

Orders for other respiratory viral testing panels or assays will **NOT** be accepted when samples are collected using this COVID-19 collection kit. These other respiratory pathogens require collection using a nasopharyngeal swab.

Anterior nares specimen collection can be performed by a healthcare worker or can be performed by a patient in the presence of a healthcare worker.

### PLEASE NOTE:

Submit only one collection per patient. When collecting the sample, take care not to touch the swab to any surface other than the point of collection. Once collected the entire swab should be immediately placed in the sterile saline container and the screw cap secured tightly.

## Sample submission

Label collection tube containing the sample with 2 unique patient identifiers such as name and date of birth and place in biohazard specimen bag. Ensure bag is subsequently sealed.

Freeze specimen and keep frozen.

Submit sample on one laboratory requisition, with test code 139900 – COVID-19. Request must include the patient's name, gender, race and ethnicity, complete address, phone number, and appropriate diagnosis code. Billing and/or insurance information should be provided on the laboratory requisition including client account number.

To avoid delays in turnaround time when requesting multiple tests on frozen samples, please submit separate frozen specimens for each test requested.

## Shipping and Storage

Ship frozen at -20°C (preferred); refrigerated specimens acceptable (if received for testing within 72 hours of collection); room temperature swabs acceptable (if received within 24 hours of collection).



## Collection Instructions



Take one of the cotton swabs out of its package. Do not touch the cotton tip of the swab with your hands. You will only need one of the cotton swabs, but the rest have been provided as backups.



Screw off the top of the collection tube. Hold swab in one hand and collection tube in the other, being careful not to spill the liquid. Do not drink the liquid.

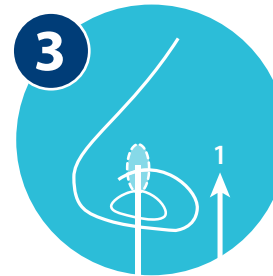

Insert the tip of the cotton swab into one nostril. The cotton swab does not need to be inserted far – insert just until the cotton tip of the swab is no longer visible. Rotate the swab in a circle around the entire inside edge of the nostril at least 3 times.

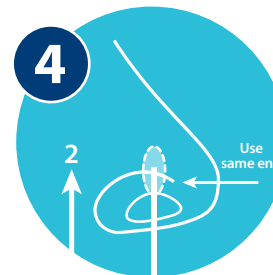

Take the cotton swab out of the nostril. Using the same end of the cotton swab, repeat step 3 in the other nostril.

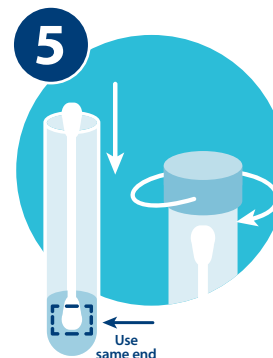

Remove the cotton swab from the second nostril and place in the collection tube. The end of the cotton swab that went into the nose should be placed into the tube first so that it sits down in the liquid. Screw the top of the collection tube back on.